

Pump Volute Gasket Repair Kit Instructions

This kit contains only one casting. Parts 1, 2 and 3 (pictured below) are not used on the new style of pump mount boilers and heaters. The new casting is a combination of part 1 and part 3, they are cast as a single part. If your boiler has the new style, it is a one for one replacement. If your boiler is of the old style (pictured below), discard parts 1, 2, 3 and 4. Replace with the parts contained in this kit.

1. Isolate the boiler from gas, electricity and water.
2. Mark the pump volute and adapter plate such that the new and old parts cannot be confused with one another.
3. Remove the pump from the volute so as to expose the pump impeller. Destroy the large round gasket so as not to get it confused with the new one in the kit.
4. Remove the pump volute from the adapter plate. Destroy the pump volute rubber gasket so as not to get it confused with the new one in the kit.
5. Remove the adapter plate from the heat exchanger header. Destroy the adapter plate rubber gasket so as not to get it confused with the new one in the kit.
6. Reassemble using the new parts. Be certain the water barrier is in place and all of the gaskets are properly seated. **Torque the pump volute bolts to 25 ft-lbs. Check the bolt torque one hour after initial tightening to be certain the bolts have retained the 25 ft-lb torque setting. If the bolts are less than 25ft-lbs, re-tighten.**
7. Test the boiler to ensure proper operation.

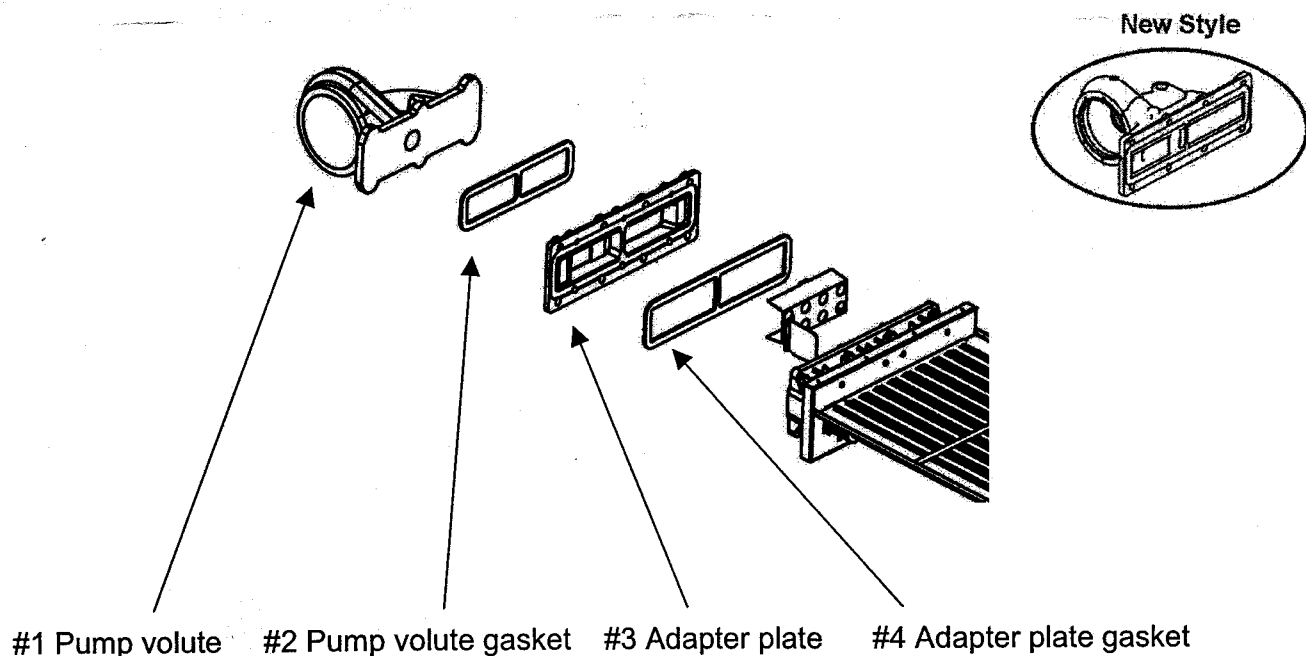

LAARS 
Heating Systems Company
 A subsidiary of BRADFORD WHITE Corporation

20 Industrial Way, Rochester, NH 03867 • 603.335.6300 • Fax 603.335.3355
 1355 Kuehner Drive, Simi Valley, CA 93063 • 800.900.9276 • Fax 800.559.1583 (Sales, Service)
 480 S. Service Rd. West, Oakville, Ontario, Canada L6K 2H4 • 905.844.8233 • Fax 905.844.2635
www.Laars.com

1 lth in U.S.A. © Laars Heating Systems 0508